

FACHADA LATERAL DIREITA
ESC.: 1/50

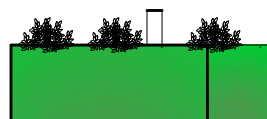

FACHADA LATERAL ESQUERD
ESC.: 1/50



FACHADA LATERAL
ESC.: 1/50



FACHADA FRONTAL
ESC.: 1/50

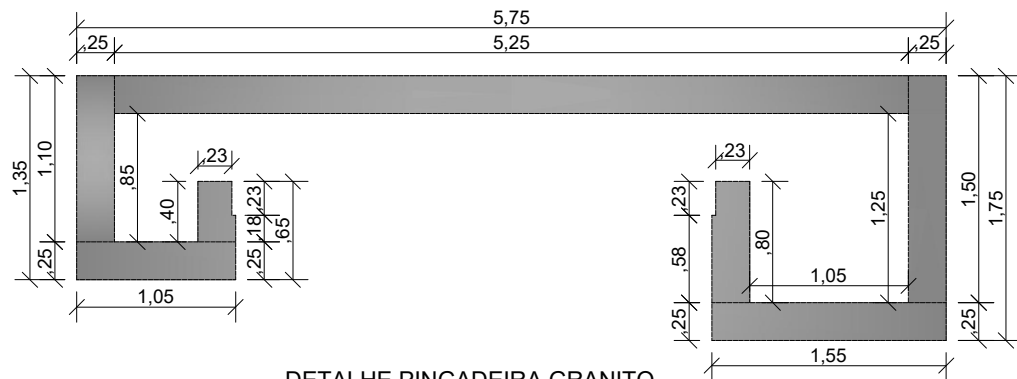

DETALHE PINGADEIRA GRANITO
ESC.: 1/50

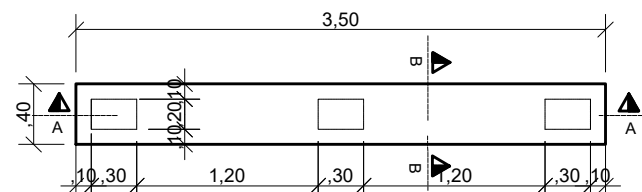

PLANTA BAIXA
ESC.: 1/50

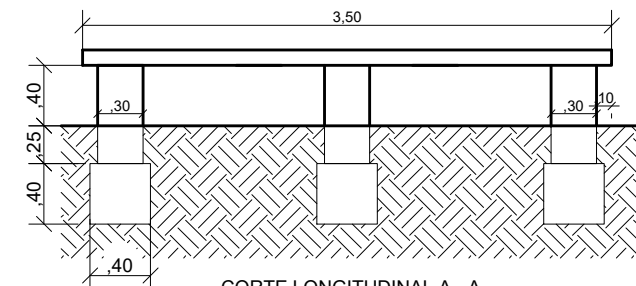

CORTE LONGITUDINAL A - A
ESC.: 1/50

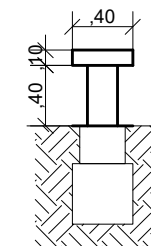

CORTE TRANSVERSAL B-B
ESC.: 1/50

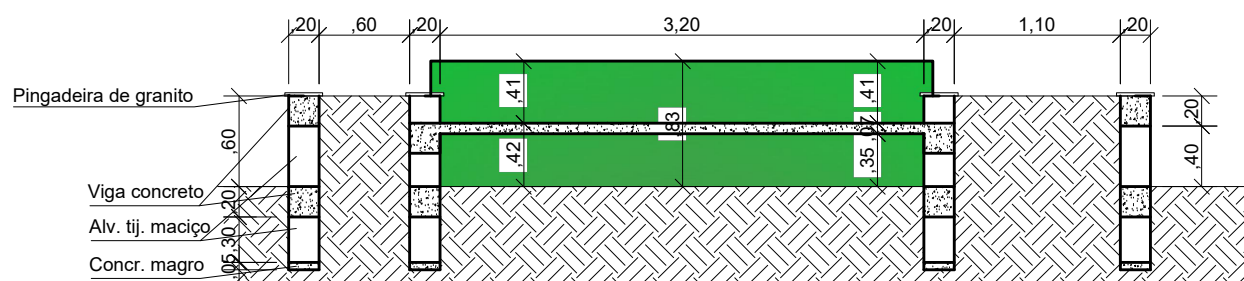

CORTE LONGITUDINAL A - A
ESC.: 1/50

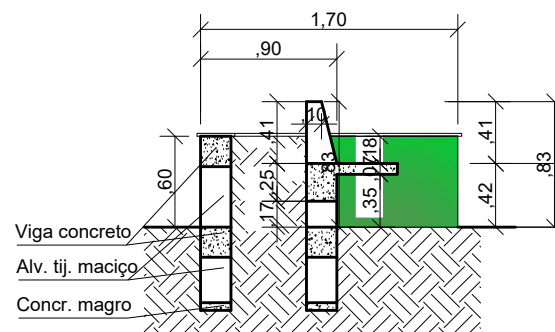

CORTE TRANSVERSAL B - B
ESC.: 1/50



FACHADA FRONTAL
ESC.: 1/50

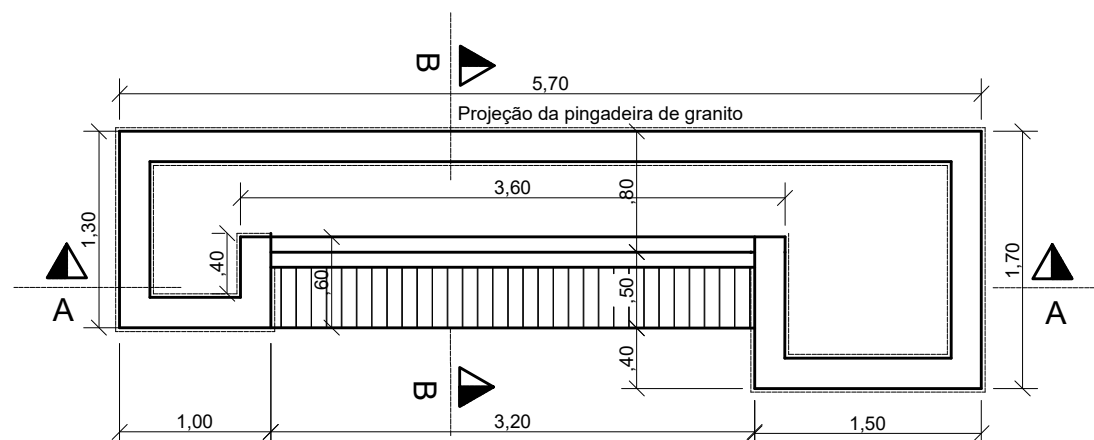

PLANTA BAIXA
ESC.: 1/50

MUNICÍPIO DE CONSTANTINA-RS

FIDELVINO MENEGAZZO
Prefeito Municipal

RESP. TÉCNICO:

RENATA CENCI SIGNOR
ENGº. CIVIL CREA RS 093177

PROPRIETÁRIO: PREFEITURA MUN. DE CONSTANTINA

OBRA: MELHORIA NA PRAÇA GETÚLIO VARGAS

REFORMA DO PARQUE INFANTIL

LOCAL: Av. João Mafessoni, Centro, Constantina - RS

DETALHE DA FLOREIRA COM BANCO E BANCO DE CONCRETO

DATA:
SET/2023

ESCALA:
INDICADA

ÁREA:
1.021,00m²

DESENHO
RENATA

PRANCHA:
02/03