

**CORTE LONGITUDINAL BLOCO "B"**  
ESC.: 1/50

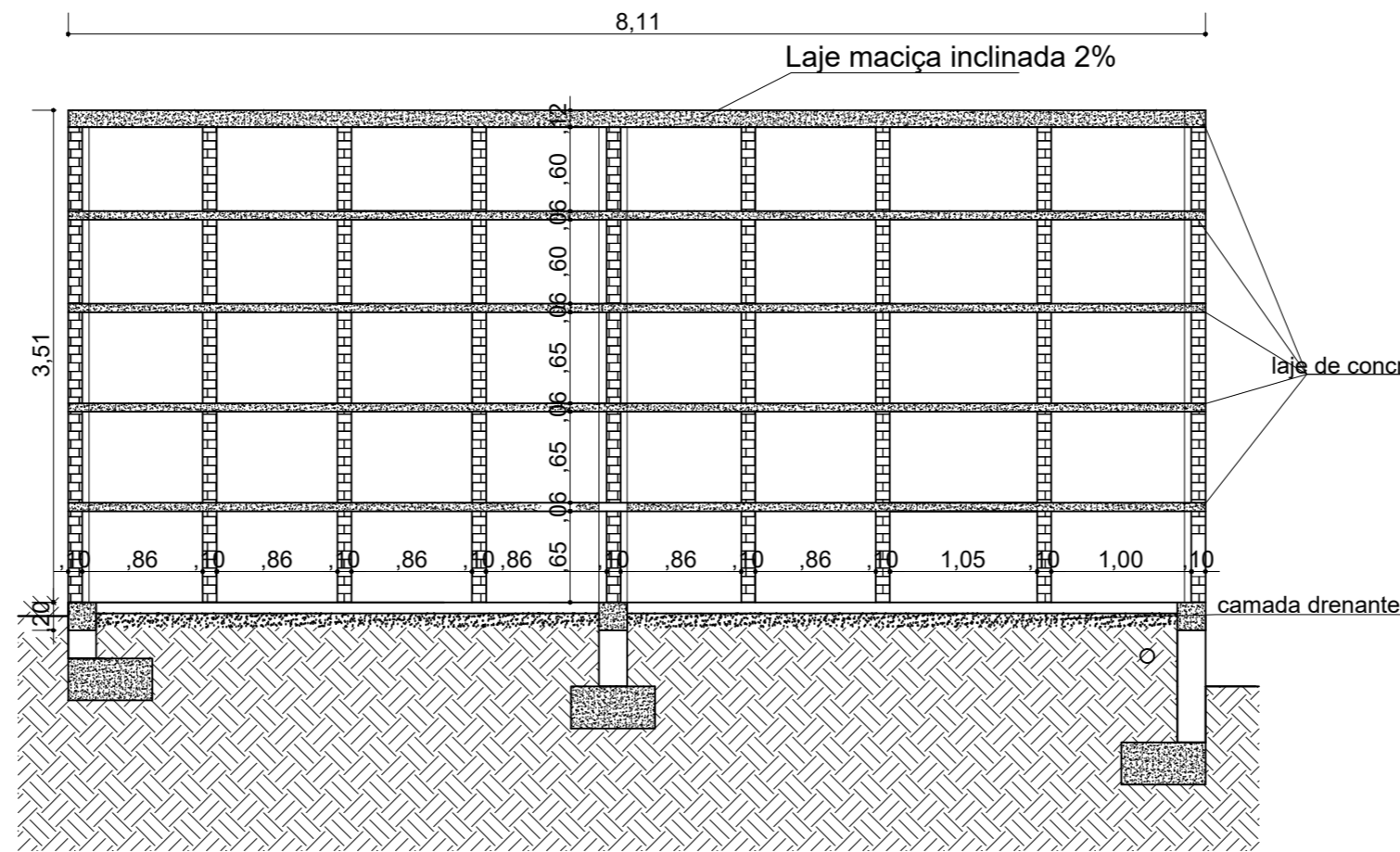

**CORTE LONGITUDINAL - BLOCO "A"**  
ESC.: 1/50

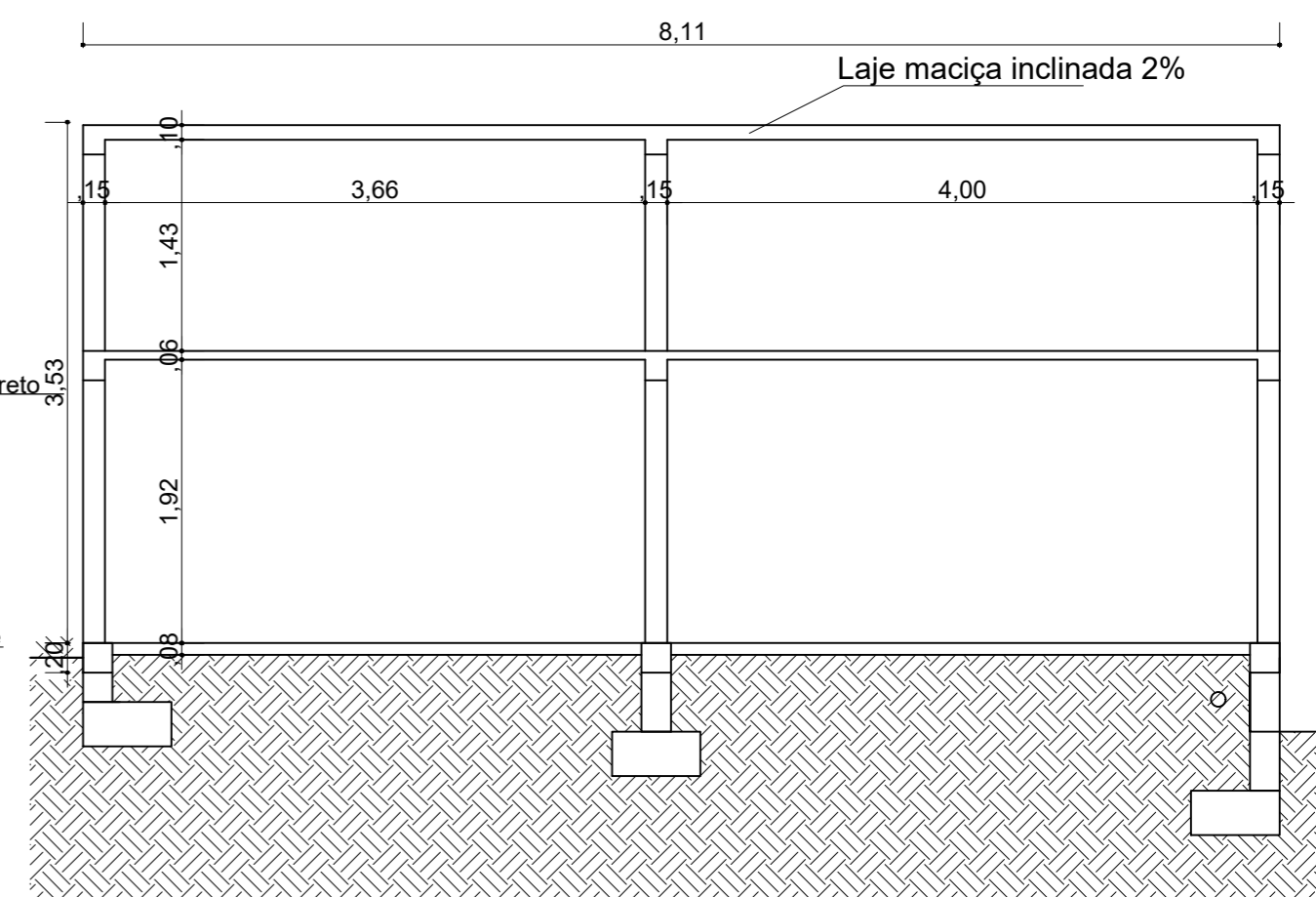

**PROJETO ESTRUTURAL BLOCO "A"**  
ESC.: 1/50

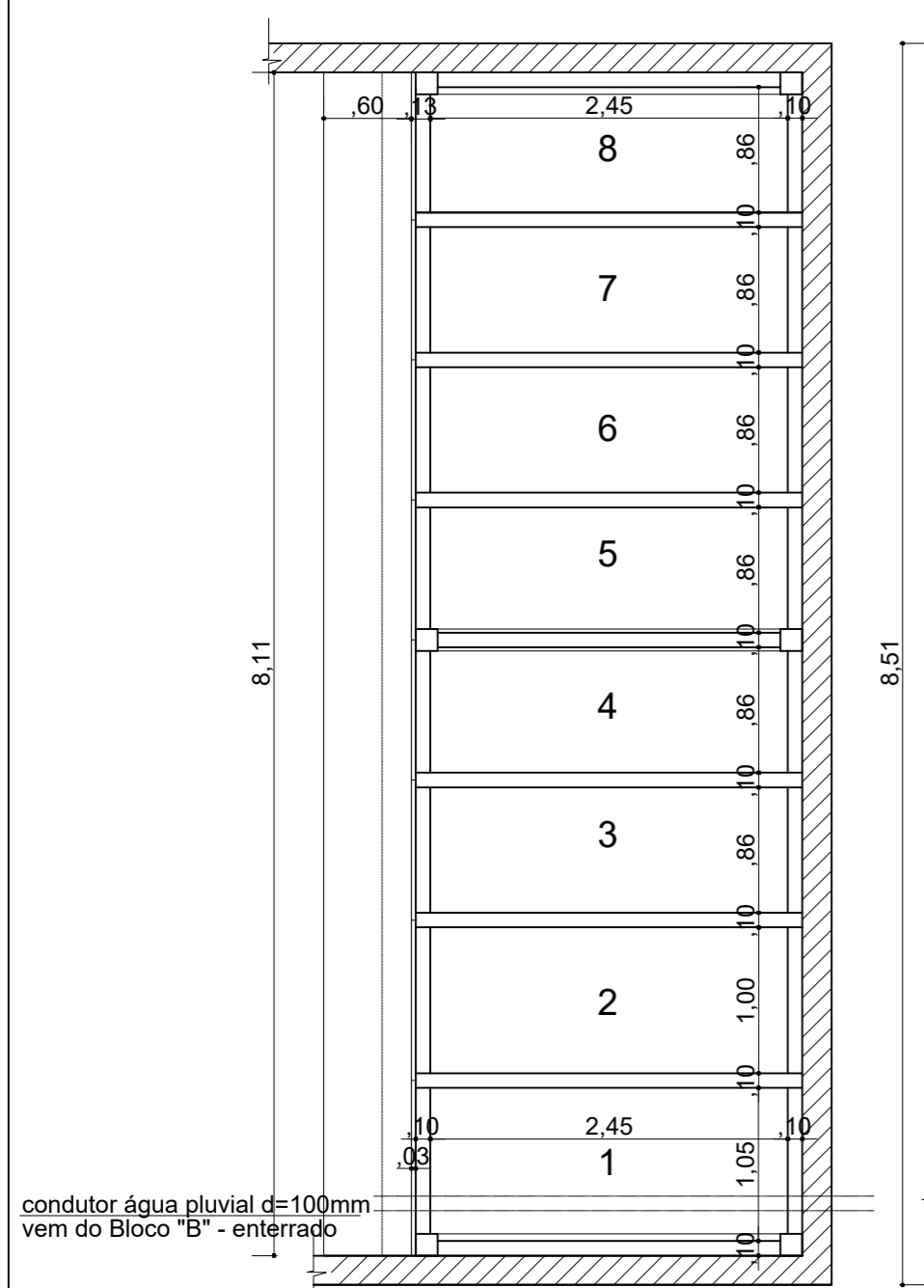

**PLANTA BAIXA - BLOCO "A"**  
ESC.: 1/50  
A= 21,73m<sup>2</sup>

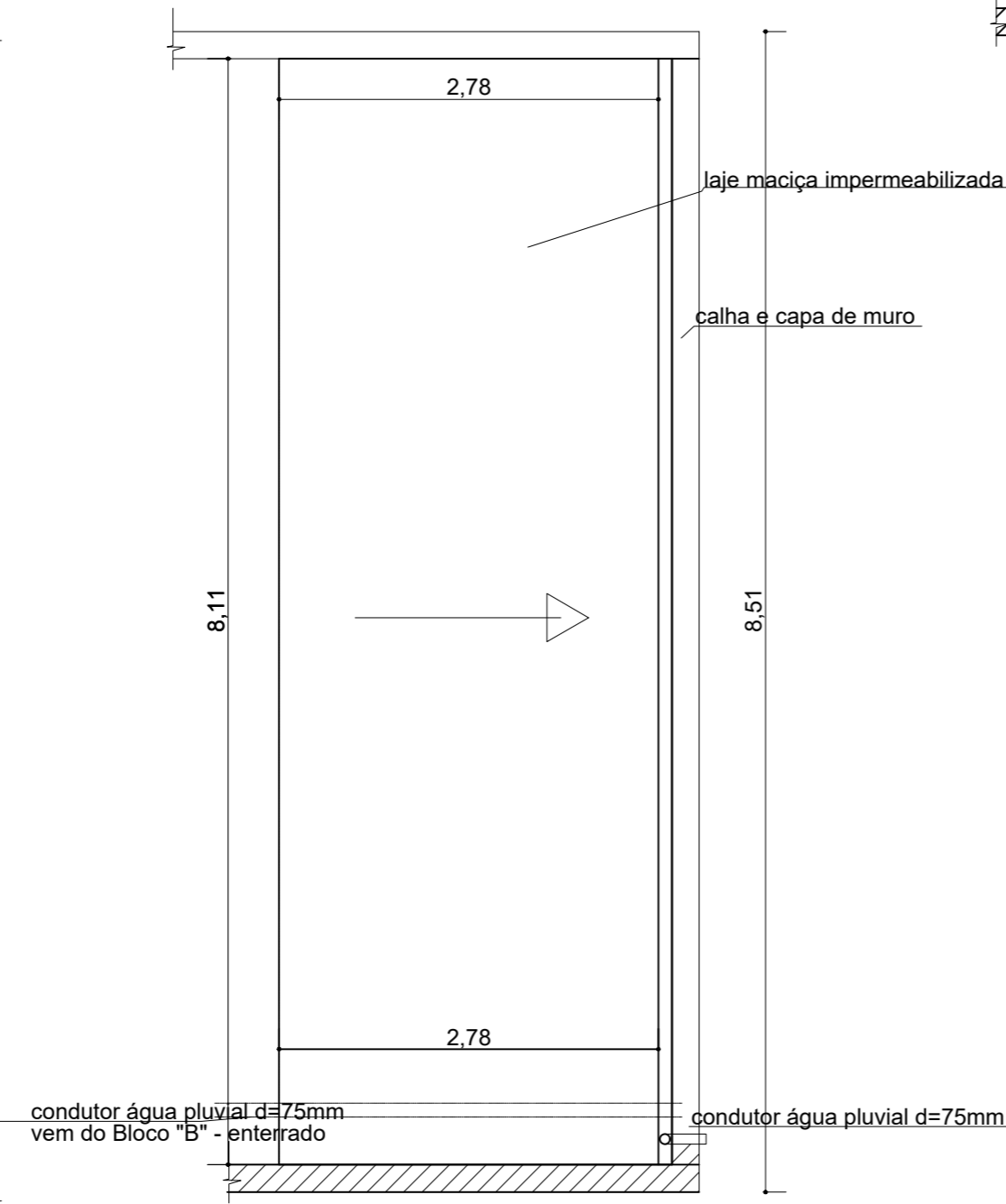

**PLANTA DE COBERTURA - BLOCO "A"**

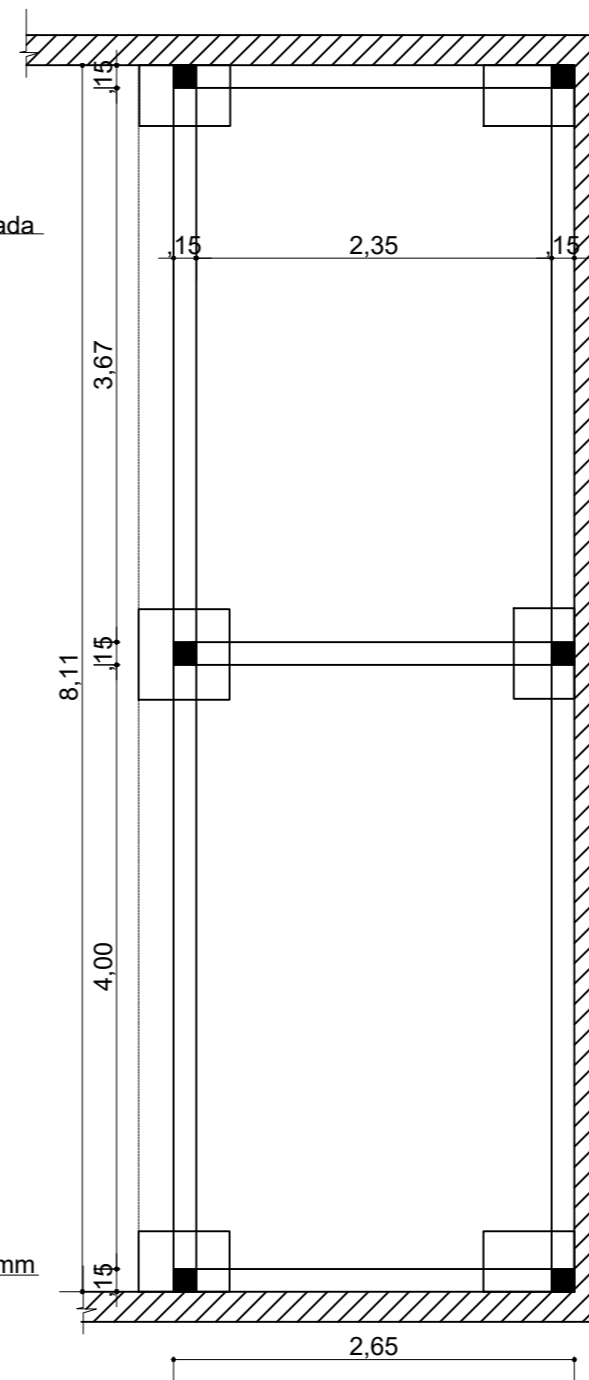

**PLANTA DE FORMAS BLOCO "A"**  
ESC.: 1/50

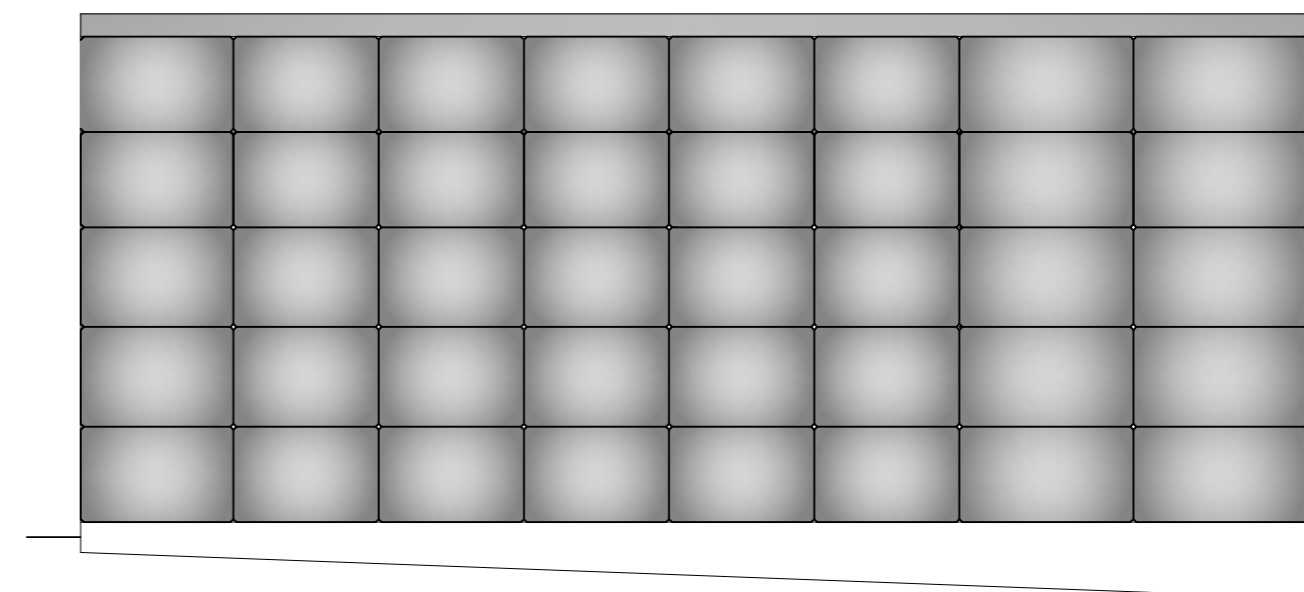

**FACHADA BLOCO "B"**  
ESC.: 1/50



MUNICÍPIO DE CONSTANTINA-RS

FIDELVINO MENEGAZZO  
Prefeito Municipal

PROPRIETÁRIO: PREFEITURA MUN. DE CONSTANTINA  
OBRA: PROJETO AMPLIAÇÃO CEMITÉRIO  
LOCAL: CONSTANTINA/RS

RESP. TÉCNICO:

RENATA CENCI SIGNOR  
ENG. CIVIL CREA RS 093177

**BLOCO "A" - PROJETO ARQUITETÔNICO E ESTRUTURAL**

DATA:  
MAIO/2023

ESCALA:  
INDICADA

ÁREA:  
21,73m<sup>2</sup>

DESENHO  
RENATA

PRANCHA:  
**02/03**